

LIGHT SOURCE

| | | | |
|----------------------------|--|--|--|
| LED quantity | 1 | | |
| Power max | 3 W – 6 W – 9 W | | |
| Total lumen output (3000K) | 3W: 3° - 166 lm | 6W: 10° - 461 lm 30° - 399 lm 50° - 367 lm | 9W: 10° - 594 lm 30° - 513 lm 50° - 455 lm |
| Efficacy lm/W (3000K) | 3W: 3° - 55 lm/W | 6W: 10° - 77 lm/W 30° - 66 lm/W 50° - 61 lm/W | 9W: 10° - 66 lm/W 30° - 57 lm/W 50° - 50 lm/W |
| CRI | >80 – >90 | | |
| LED Temperature | 2700K – 3000K – 3000K CRI>90 – 3500K - 4000K | | |
| Average operational life | 50.000 hours | | |

OPTIC

| | |
|------------------|---------------------------------------|
| Material | PMMA lens /glass cover |
| Available optics | 3°- 10°- 30° - 50° |
| Beam direction | Adjustable +/-160°, rotating +/- 355° |
| Flux symmetry | Symmetrical |

FIXTURE

| | |
|---------------------------|--|
| Material | Aluminum |
| Available finishes | Hard coat anodized: 3 - Gray 4 - Black Powder coating: 4A – Anthracite grey MF – Moka WB – Olive green |
| IP Rate | IP67 |
| Working Temperature | -20° ÷ +40° |
| Integrated fixing Systems | Applique |

ELECTRICAL FEATURES

| | |
|------------|------------------------------------|
| Driver | Remote |
| Dimmable | Push, 1-10V, DALI |
| Connection | In series at 500mA – 700mA – 900mA |
| Class | III |

MECHANICAL FEATURES

| | |
|--------------|-------------------------------|
| Dimensions | Ø50 x 106 x 350-500 mm |
| Weight | 570 gr (H350) – 670 gr (H500) |
| Installation | Wall, ceiling, floor mounting |
| Cut-out | - |
| Use | Outdoor |

ACCESSORIES

| | |
|---------------|--|
| Visors | Low glare visor, low glare snoot |
| Filters | - |
| Fixing system | Stainless steel stake, anchor for concrete |

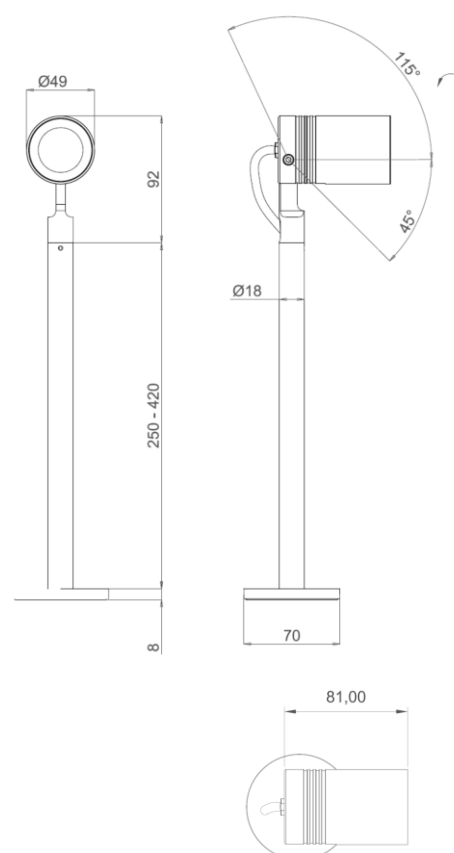

A00519_0 Low glare visor



A00848_0 Low glare snoot

PHOTOMETRIC DATA

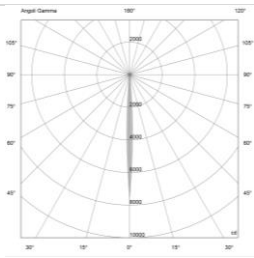
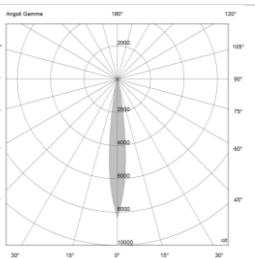
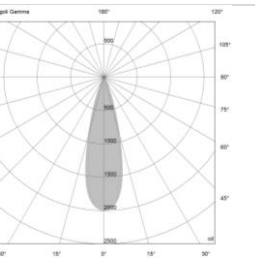
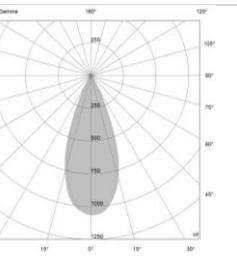
| 3° Lens – 3W | | | | 10° Lens – 9W | | | | 30° Lens – 9W | | | | 50° Lens – 9W | | | |
|---|------|-----------------------|----------------------|---|------|-----------------------|----------------------|--|------|-----------------------|----------------------|---|------|-----------------------|----------------------|
|  | | | |  | | | |  | | | |  | | | |
| H(m) | D(m) | E _{max} (lx) | E _{av} (lx) | H(m) | D(m) | E _{max} (lx) | E _{av} (lx) | H(m) | D(m) | E _{max} (lx) | E _{av} (lx) | H(m) | D(m) | E _{max} (lx) | E _{av} (lx) |
| 3° | | | | 10° | | | | 30° | | | | 50° | | | |
| <u>1.00</u> | 0.08 | 7700 | 4569 | <u>1.00</u> | 0.21 | 8339 | 5186 | <u>1.00</u> | 0.51 | 2006 | 1291 | <u>1.00</u> | 0.72 | 1062 | 640 |
| <u>2.00</u> | 0.16 | 1925 | 1142 | <u>2.00</u> | 0.42 | 2085 | 1296 | <u>2.00</u> | 1.02 | 501 | 323 | <u>2.00</u> | 1.43 | 266 | 160 |
| <u>3.00</u> | 0.24 | 856 | 508 | <u>3.00</u> | 0.63 | 927 | 576 | <u>3.00</u> | 1.54 | 223 | 143 | <u>3.00</u> | 2.15 | 118 | 71 |
| <u>4.00</u> | 0.31 | 481 | 286 | <u>4.00</u> | 0.84 | 521 | 324 | <u>4.00</u> | 2.05 | 125 | 81 | <u>4.00</u> | 2.86 | 66 | 40 |
| <u>5.00</u> | 0.39 | 308 | 183 | <u>5.00</u> | 1.05 | 334 | 207 | <u>5.00</u> | 2.56 | 80 | 52 | <u>5.00</u> | 3.58 | 42 | 26 |

NOTES

Provided with 200 cm neoprene